

## TIRADORES CURVADOS DE UNA SOLA PIEZA

Tubular Handle made entirely in aluminum, stainless steel or brass - Poignées tubulaire fabriqué complètement dans aluminium, Inox ou laiton

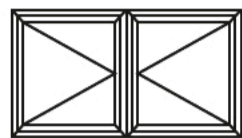

MATERIALES	ALUMINIO LACADO	ACERO INOXIDABLE
MATERIALS	PAINTED ALUMINIUM	STAINLESS STEEL
REF.:	<b>545</b>	<b>541</b>
	AL	Inox
	AL	Inox
	Latón Brass	Latón Brass
	Steel Acero	Steel Acero
	Ø 12,5	Ø 12,5
	2 Und.	2 Und.

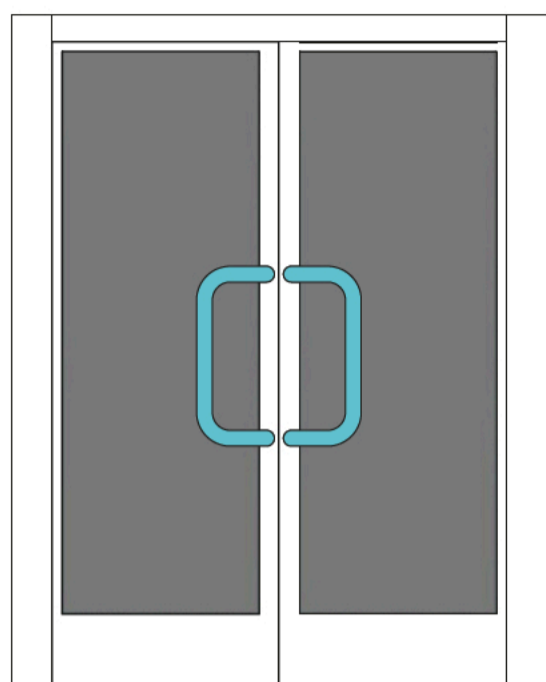
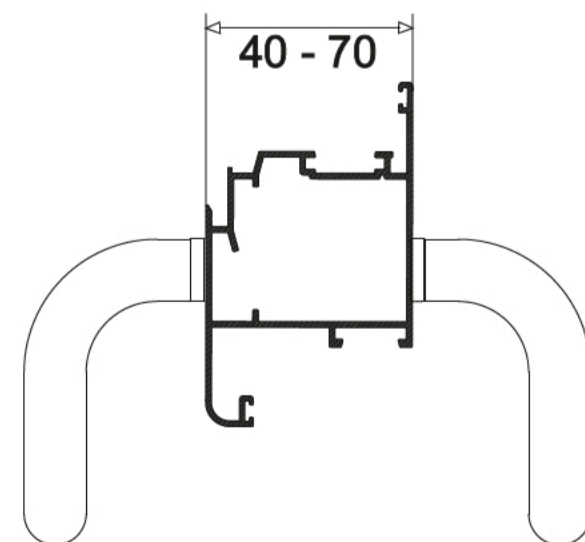
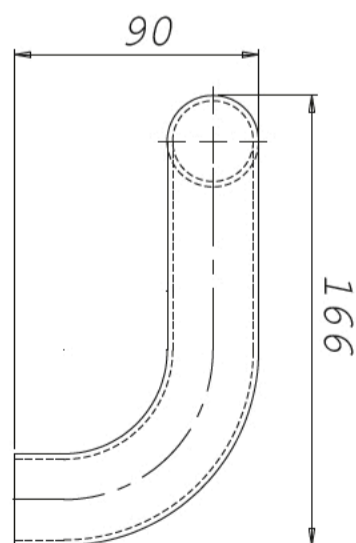
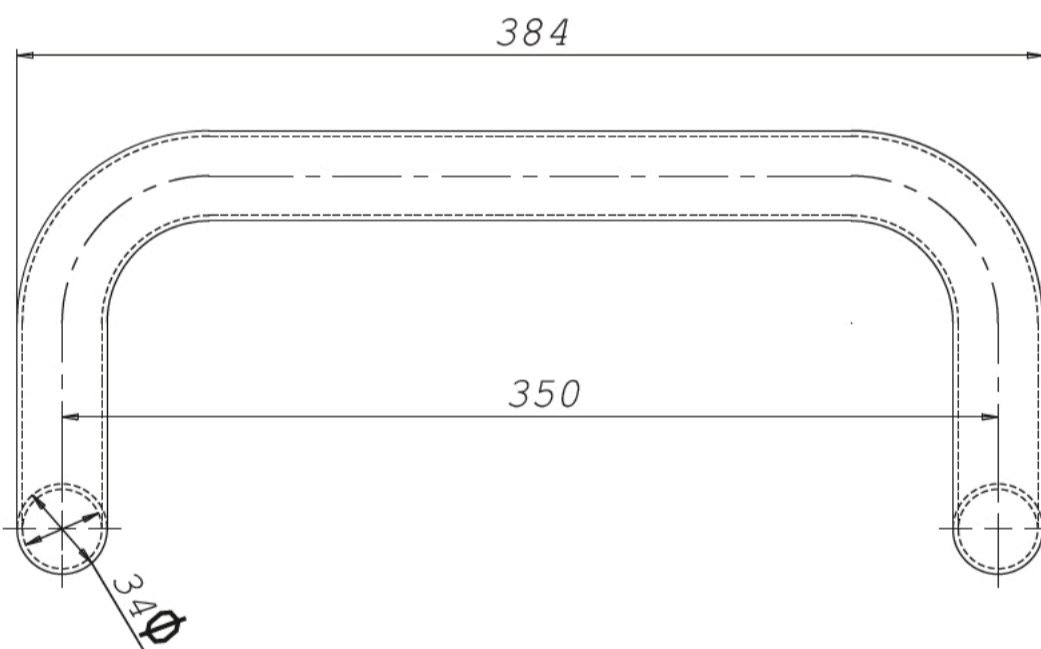

RAL 9010	RAL 9011		PLATA SILVER ARGENT	INOX	BRONCE BRONZE